

P E R M I T

CITY OF NAPOLEON
255 W. RIVERVIEW AVE
NAPOLEON, OHIO 43545

DIVISION OF BUILDING & ZONING
PH (419) 592-4010
FAX (419) 599-8393

DeAncrest Dr Apt 21

PERMIT NO: 1738

DATE ISSUED: 07-10-03

ISSUED BY: TJK *7/13*

JOB LOCATION: *324 W MAIN ST*

EST. COST: 20350.00

LOT #:

SUBDIVISION NAME:

OWNER: BECHTOL, JOHN
ADDRESS: *324 W MAIN ST*
CSZ: NAPOLEON, OH 43545
PHONE: 419-758-3350

AGENT: QUALITY AFFORDABLE C
ADDRESS: PO BOX 971
CSZ: BRYAN, OH 43506
PHONE: 419-636-7665

USE TYPE - RESIDENTIAL:

OTHER:

ZONING INFORMATION

DIST: LOT DIM: AREA: FYRD: SYRD: RYRD:
MAX HT: # PKG SPACES: # LOADING SP: MAX LOT COV:

BOARD OF ZONING APPEALS:

WORK TYPE - NEW: REPLMNT: ADD'N: ALTER: REMODEL:

WORK INFORMATION

SIZE - LGTH: WIDTH: STORIES: LIVING AREA SF:
GARAGE AREA SF: HEIGHT: BLDG VOL DEMO PERMIT:

WORK DESCRIPTION
REMODEL

FEE DESCRIPTION PAID DATE FEE AMOUNT DUE

ELECTRICAL PERMIT		15.00
PLUMBING PERMIT		9.00
MECHANICAL PERMIT		18.00
BUILDING PERMIT		53.00

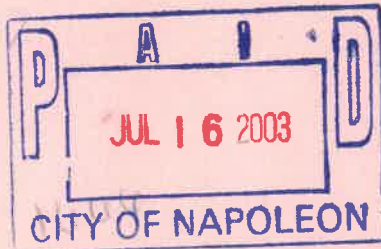

TOTAL FEES DUE 95.00

DATE *07 18 03*

APPLICANT SIGNATURE

[Handwritten Signature]

*50
25
25
100
400*

[Handwritten mark]

07 16 03

[Handwritten mark]

07 16 03

DIVISION OF BUILDING & ZONING
1419 505-4019
FAX (419) 599-8333

PERMIT

CITY OF NAPOLEON
222 W. RIVERVIEW AVE
NAPOLEON, OHIO 43542

15 Apr 01

PERMIT NO: 1758 DATE ISSUED: 07-19-01 ISSUED BY: TIR

JOB LOCATION: 224 N MAIN ST EST. COST: 10000.00

LOT #: SUBDIVISION NAME:

OWNER: BRIGHT, JOHN
ADDRESS: 224 N MAIN ST
CITY: NAPOLEON, OH 43542
PHONE: 419-758-3388
AGENT: QUALITY REORDABLE C
ADDRESS: PO BOX 971
CITY: BRYAN, OH 43206
PHONE: 419-432-7592

USE TYPE - RESIDENTIAL: OTHER:

ZONING INFORMATION

DIST: LOT DIM: AREA: YARD: STRIP: YARD:
MAX HT: # ENG SPACES: # LOADING SP: MAX LOT COV:

BOARD OF ZONING APPEALS

WORK TYPE - NEW: EXIST: ALTER: REMODEL:

WORK INFORMATION

FLOOR AREA SF: HEIGHT: WIDTH: LIVING AREA SF:
CUBIC VOL DEMO PERMIT: ALSO VOL DEMO PERMIT:

WORK DESCRIPTION
REMODEL

FEE DESCRIPTION PAID DATE FEE AMOUNT DUE

33.00
18.00
3.00
12.00

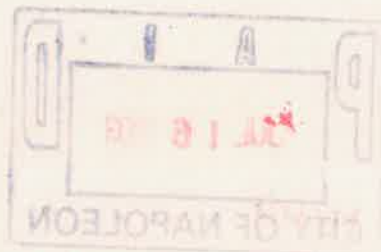

BUILDING PERMIT
MECHANICAL PERMIT
PLUMBING PERMIT
ELECTRICAL PERMIT

TOTAL FEES DUE 66.00

APPLICANT SIGNATURE

DATE 07 18 01

Handwritten signature and date: 07 18 01

07 18 01

Handwritten signature

07 18 01

Handwritten signature

Contractor - Quality Affordable

John Bechtol
324 W. Main St.
Napoleon, Ohio 43545

Unit# R7

City of Napoleon Rental Rehab Specifications

phone (419) 758 - 3350

1. Roofing: Remove all of the existing roof covering, down to the sheathing. Mechanically fasten 7/16 roof sheathing to roof deck. Excluding the front porch roof, secure 15# felt to roof sheathing and secure aluminum drip edge to roof perimeter. Install, per manufacturer's instruction, minimum 240# test weight, Class A fire rated, 30 year warranty fiberglass dimensional roof shingles and cap shingles. Properly flash all roof outlets. **Homeowner to select shingle color.**

To the front porch roof, properly affix 1/2" black insulation/backer board to garage roof area and glue down EPDM rubber roof membrane. Secure aluminum drip edge to roof perimeter and cover with glued EPDM materials. Flash all roof outlets with EPDM materials.

6,125.00

BU

2. Gutters/downs: Fasten white seamless aluminum gutters along the eave edges. Secure downspouts to the gutters and exterior walls, using proper hardware. Place splash blocks under each downspout.

925.00

3. Exterior doors: Replace the TWO (2) rear entry doors with Stanley, Therma-Tru, or equal quality pre-hung insulated steel doors with light. Doors must be factory painted or contractor applied (TWO coats). **Homeowner to select door style and color from contractor options.** Contractor must repair all damage incurred from door replacement.

Install Kwikset-Belaire Series or equal quality lockset with dead-bolt lock. **Locks must be keyed alike.**

Install Louisiana Pacific, Larsen, or equal quality self-storing/ solid kick panel/ storm door with all safety glass and insect screen at the front and rear entry doors. **Total of TWO doors.**

1,750.00

BU

4. Electrical:

Basement - Install a single receptacle, secured to floor joist near the water heater.

Electrical panel - Trace and properly label each circuit in the panel.

Build a chase or install exposed electrical wiring in conduit.

Kitchen - GFCI protect the TWO (2) counter receptacles on the south wall.

Replace the work light (near sink) with a wall switched, enclosed fluorescent fixture.

Play room - Install TWO (2) additional wall receptacles. Locate at each the east wall and west wall (south of closet door).

Replace the closet light with a wall switched, enclosed fluorescent fixture.

Bathroom - Install a gfci protected receptacle near the vanity.

Install a wall switch to control the vanity light bar.

Livingroom/diningroom – Install THREE (3) additional wall receptacles. Locate at each the east wall (north of bedroom entry), south wall (west of exterior door) and west wall (below window in livingroom area).

Remove the floor mounted receptacles and electrical feed on the west wall of dining area.

Bedroom (1st floor) – Install FOUR (4) additional wall receptacles. Locate at each the north wall, south wall, and two on the west wall (north and south of closet door).

Replace the closet light with a wall switched, enclosed fluorescent fixture.

2nd floor landing – Install ONE (1) additional wall receptacles. Locate on the north wall. Install a wall switch to control the wall mounted light.

Bedroom #2 (2nd flr/south) – Install TWO (2) additional wall receptacles. Locate at each the south wall and north wall (east of entry door).

Smoke detectors – Install FIVE (5) U.L approved hardwired smoke detectors, wired in series. Locate at each the basement, bedroom #1, dining/living near bedroom, bedroom #2, and second floor landing.

CO detector – Install a U.L approved hardwired CO detector in the basement stairs at the top landing.

Exterior – Install TWO (2) weather resistant GFCI receptacles near each the front and rear entry.

NOTE: All electrical work must conform to NEC and be performed by qualified technician(s).

EL-15.00

4,500.00

5. Plumbing:

Water heater – Replace the water heater with 40 gallon natural gas fired water heater, equipped with "power vent", vented through the north foundation wall. New tank must have thermal expansion device, shut-off valve to the supply line, di-electric water line fitting at the tank, temp./pressure relief valve, and 3/4" copper extension line from the relief valve to within 3" of floor.

Kitchen – Replace the sink drain trap with a "p" trap. Install gated shut-off valves to the water supply lines.

Bathroom – Replace the sink drain trap with a "p" trap.

Exterior – Install TWO (2) exterior sill cock with frost-proof sill cock, with vacuum break at existing spigot locations (front and rear).

NOTE: All plumbing work must conform to The Ohio Plumbing Code

PL-9.00

1,725.00

6. Heating: Install a 90%+ efficient natural gas fired forced air furnace in the basement area to distribute conditioned air to all of the rooms throughout the home. Furnace must be properly sized by a licensed furnace contractor or supplier. Properly vent new furnace through the basement wall. New furnace must be installed in accordance with manufacturer's recommendations and professional installation standards. Supply housing inspector with sizing chart and duct work lay out before heating work is to begin.

ME-18.00

Replace all soft copper gas supply lines with black iron with drip leg and shut-off valves at all gas appliances.

NOTE: All heating work to conform to The Ohio Plumbing Code and CABO One and Two Family Dwelling Code. Heating contractor is responsible for repairing all areas damaged by furnace installations. All repairs to match existing surfaces.

PK

2,900.00

7. Interior carpentry:

Rear enclosed porch – North of the basement stair well, secure pre-painted baluster.

Basement stairs – Install a pre-finished hardwood handrail, secured by metal handrail brackets.

Replace the TWO (2) bottom steps.

Stairs to 2nd floor – Install a pre-finished hardwood handrail, secured by metal handrail brackets, properly secured to wall studding.

Front porch – Secured pre-painted angled metal handrail.

875.00

8. Rear sidewalk – At the rear (north) entry door, remove the east to west sidewalk materials. Excavate the cistern, located near the rear door, and collapse the sides and back fill with stone. Construct forms for approach pad and sidewalk to the entry. Approach dimensions... 4" thickness X 6' wide X 5' length. Sidewalk dimensions ... 4" thickness X 4' wide X approximately 10' long. Lay 2" of river sand and properly tamp and prepare bed to pour approaches and sidewalk. Lay and tie together 1/2" rebar (on 2' spacing) in constructed approach and sidewalk forms. Pour 4" thickness slab and sidewalk with 2,500 pound concrete mix. Trowel in expansion joints every 3' and properly trowel edges. Broom finish the surface of the pad and sidewalk. Apply concrete sealer to surface of sidewalk and pad.
Contractor must contact housing inspector for pre-pour inspection of pad and sidewalk preparation.

1,500.00

TOTAL PROJECT BID 20,350.00

June 30 Napoleon bid round addendums

324 W. Main St

J. Bechtol/ Unit #R7
324 W. Main St.
Napoleon, Ohio

1. Roofing.

ADD... Remove the chimney, after furnace and water heater replacements have been completed.

4. Electrical.

Change... Locate CO detector in basement.

J. Bechtol/ Unit #R8
515 W. Clinton St.
Napoleon, Ohio

Foundation + How?

1. Foundation.

Change... Replace and rebuild foundation materials at the west wall, near south window.

ADD... Replace the missing glass pane of the south window on the west wall.

1.03. Soffit/fascia.

ADD... Wrap porch headers and install soffit to porch ceiling.

8. Misc. carpentry.

Change... Install a handrail to the rear entry and basement steps.

Scott Wiler/ Unit #DP4
1125 Stevenson
Napoleon, Ohio

1. Ext. doors.

ADD... Re-install existing storm doors at front and side entry.

2. Roofing.

ADD... Secure 7/16" sheathing to roof deck.

OMIT specification # 3. Replacement windows.

L17
784-3882



18 1/2

John Bechtol
515 W. Clinton St.
Napoleon, Ohio 43545

Unit# R8

City of Napoleon Rental Rehab. Specifications

phone (419) 758 - 3350

7x6	42	15x30	450	1674
7x6	42	9x12	108	167
10x44	440	9x12	108	1841
11x44	484			1290

1. **Foundation:** Replace and re-build foundation materials at the south wall, near basement window.

Fill all cracks and holes, using expanding foam material. Apply water resistant cementitious materials (Thoroseal or equal product) to the interior perimeter basement walls. Apply to approximately 1/4" thickness.

Affix and seal aluminum framed, plexi-glass panels to the exterior of basement windows.

NOTE: Windows must be removable by homeowner.

2000 BU

2. **Roofing:** Remove all of the existing roof covering, down to the sheathing. Mechanically fasten 7/16 roof sheathing to roof deck. Secure 15# felt to roof sheathing and secure aluminum drip edge to roof perimeter. Install, per manufacturer's instruction, minimum 240# test weight, Class A fire rated, 30 year warranty fiberglass dimensional roof shingles and cap shingles. Properly flash all roof outlets. **Homeowner to select shingle color.**

5,600 BU

LO3. **Soffit/fascia:** Secure aluminum channel along the eave and gable overhangs. Install aluminum soffit materials to all of the overhangs.

Affix manufactured aluminum fascia coverings to all of the fascia boards.

NOTE: Homeowner to select soffit/fascia colors.

7700 BU

4. **Exterior doors:** Replace the front and rear entry doors with Stanley, Therma-Tru, or equal quality pre-hung insulated steel doors with light. Doors must be factory painted or contractor applied (TWO coats). **Homeowner to select door style and color from contractor options.** Contractor must repair all damage incurred from door replacement.

Install Kwikset-Belaire Series or equal quality lockset with dead-bolt lock. **Locks must be keyed alike.**

1600 BU

5. **Electrical:**

Electrical Panel - Install a 100 amp/ twenty space electrical breaker panel and properly wire, bond, ground, and label. Locate panel at existing panel location.

Electrical wiring - Replace ungrounded electrical wiring throughout the entire structure with properly sized and grounded wire. Replace all switches and receptacles with U.L approved devices.

Basement - Place the water heater wire in conduit.

E.L - 24,000

Place the furnace wire in conduit.

Kitchen – GFCI protect the existing counter receptacle located north of the sink.
Install ONE (1) additional gfci protected receptacle at the counter, south of the sink.
Install ONE (1) additional wall receptacle on the north wall, on a dedicated circuit, for refrigerator.

Replace the work light, above the sink, with a wall switched, enclosed fixture.

Bedroom #1 (s-east) – Install THREE (3) additional wall receptacles. Locate at each the east, west, and south walls.

Bedroom #2 (central) – Install THREE (3) additional wall receptacles. Locate at each the east, west (closet), and south walls.

Replace the closet light fixture with a wall switched, enclosed fluorescent light fixture.

Diningroom – Install THREE (3) additional wall receptacles. Locate at each the east wall, west wall (south of kitchen entry), and south wall (west of study).

Study – Install TWO (2) additional wall receptacles. Locate at each the east wall (north of closet door) and west wall.

Replace the closet light fixture with a wall switched, enclosed fluorescent light fixture.

Livingroom – Remove the TWO (2) floor mounted receptacles and electrical feeds. Place blank metal cover over electrical boxes.

Install THREE (3) additional wall receptacles. Locate TWO (2) at the north wall (ONE east and ONE west of exterior door) and ONE (1) on the south wall (west of diningroom entry).

Family room (n-east) – Install ONE (1) additional wall receptacle at the east wall, north of livingroom entry.

Secure electrical junction box extensions to the recessed receptacles.

Install a wall switched, ceiling mounted light fixture. Cost not to exceed \$30.00, less installation.

Smoke detectors – Install FOUR (4) U.L approved hardwired smoke detectors, wired in series. Locate at each the basement, bedroom #1, hallway, and bedroom #2.

CO detector – Install a U.L approved hardwired CO detector in the basement stairs at the top landing.

Exterior – Install TWO (2) weather resistant GFCI receptacles near each the front and rear entry.

Replace the garage electrical feed with UF "romex".

GFCI protect the garage wall receptacle.

NOTE: All electrical work must conform to NEC and be performed by qualified technician(s).

7,350-

6. Furnace: Replace the furnace with a 80%+ efficient natural gas forced air furnace. Furnace must be properly sized (supply sizing chart to housing specialist). Connect the furnace to the existing supply/return ducts. Install a liner kit, complete with cap, in the chimney "chase" to properly direct water heater and furnace flue gases outside the home. Furnace wire must be installed in conduit. New furnace system must have new pre-manufactured filter assembly, filter, and thermostat. Upon completion of system installation, fire furnace and perform diagnostic testing to assure proper system function.

ME # 5.00

Replace all non-black iron gas supply line, from the main to all gas appliances. Install drip leg and shut-off valve at each appliance.

Remove the existing space heater, located in rear porch, and cap off gas supply line.

Furnace installation to conform to NFPA-54 and be performed by qualified HVAC technician(s).

2300

7. Plumbing:

Water heater - Install a 3/4" copper extension pipe, from the temp./pressure relief to within 3" of floor.

Kitchen - Install gated shut-off valves to the sink water supply lines.

Bathroom - Install gated shut-off valves to the sink water supply lines.

Replace the vanity sink drain-trap with a "p" trap.

Exterior - Replace the north exterior sill cock with frost-proof sill cock, with vacuum break

NOTE: All plumbing work must conform to The Ohio Plumbing Code

600

8. Miscellaneous carpentry: Install a handrail to the rear entry steps.

+ Basement stair

300 BU

9. Replacement windows: Wrap all of the exterior window and door trim with formed aluminum coil stock materials. Homeowner to select coil trim color.

Install white vinyl replacement windows (Certaainteed, Seaway, Great Lakes, or equal quality) to all of the windows throughout the structure. Contractor must repair all damage incurred by replacing of windows.

- Kitchen - 1 slider
- Bed #1 (s-east) - 2 dble hung
- Bath - 1 dble hung (frosted)
- bed #2 (central) - 1 dble hung
- Study - 1 slider (south) and 2 dble hung (west)
- dining - 1 dble hung
- Livingroom - 2 dble hung
- Family (n-east) - 1 dble hung (east)
- and 1 slider (north)

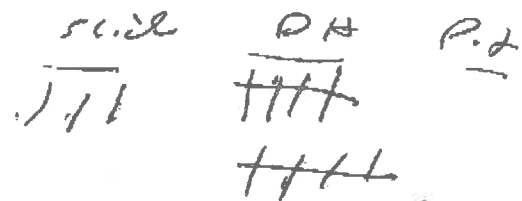
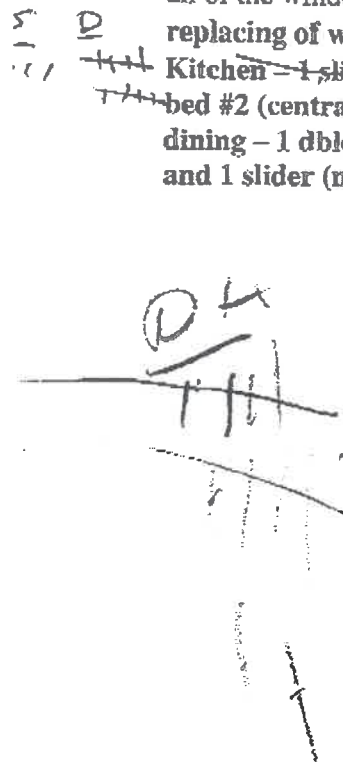

3500
~~4750~~ 3500
 4900
 4750 BU

TOTAL PROJECT BID

28,200

2500
1800

1125
2600
1200

28,200

CITY OF NAPOLEON OHIO PERMIT APPLICATION

THIS APPLICATION IS FOR RESIDENTIAL CONSTRUCTION INCLUDING BUILDING, ELECTRICAL, PLUMBING, MECHANICAL, DEMOLITION, REMODELING

DATE 7-8-03 JOB LOCATION 515 W. Clinton

LOT # _____ SUBDIVISION NAME _____

OWNER John Bechtel PHONE 419-758-3350

OWNER ADDRESS 515 W. Clinton CITY Napoleon ZIP 43545

CONTRACTOR Tri-County Roofing, Inc. PHONE 419-399-7964

CONTRACTOR ADDRESS 13771 C.R. 1102 CITY Building ZIP 45879

CONTRACTOR FAX # 419-399-9662 CELL PHONE (Opt.) _____

DESCRIPTION OF WORK TO BE PERFORMED: Total Rehab

ESTIMATED COST OF WORK TO BE PERFORMED: 28,200-

WORK INFORMATION

BUILDING: Basement Floor Area _____ Sq. Ft. 1st Story Living Area _____ Sq. Ft.
2nd Floor Living Area _____ Sq. Ft. Garage Floor Area _____ Sq. Ft.

BUILDING SIZE: Length _____ Width _____ Stories _____ Height _____ DEMO VOL _____

*Masonry Contractor _____ Phone _____ Fax _____
Address _____ City _____ St _____ Zip _____

Electrical Contractor Tri-County Phone _____ Fax _____
Address _____ City _____ St _____ Zip _____

Plumbing Contractor Tri-County Phone _____ Fax _____
Address _____ City _____ St _____ Zip _____

Heating Contractor Gardner's HVAC Phone 542-9013 Fax _____
Address 108 E. High St. City HICKSVILLE St OH Zip 43526

Insulation Contractor _____ Phone _____ Fax _____
Address _____ City _____ St _____ Zip _____

Other Contractor attach information.

ZONING INFORMATION (to be completed by City): District _____ Lot Dimensions _____
Lot Area _____ FRSB _____ SYSB _____ RYSB _____ Max Ht _____ ft Max Cov _____ %

I, by signing below agree to comply with all applicable City of Napoleon Codes & Ordinances while performing the work herein described. I understand that all work for which a permit is issued is required to be approved by the building inspector of the City of Napoleon.

Applicant Signature Jessica Haynes Date 7-8-03

CITY OF NAPOLEON INSPECTION FORM

PERMIT #: 1738

DATE ISSUED: 07-10-2003

JOB LOCATION: 324 W MAIN ST

OWNER: BECHTOL, JOHN

OWNER PHONE: 419-758-3350

CONTRACTOR: QUALITY AFFORDABLE CONST.

CONTRACTOR PHONE: 419-636-7665

WORK DESCRIPTION: REMODEL

PLUMBING: UNDGR _____ RGHIN _____ FINAL _____

SEWER INSP _____

MECHANICAL: UNDGR _____ RGHIN _____ FINAL _____

FURNACE REPLC _____ AIR COND _____

ELECTRICAL: UNDGR _____ RGHIN _____ FINAL _____

SERV UPGR _____

BUILDING: SITE _____ FTG _____ FNDT _____

STRUC _____ ROOF _____ EXT _____

VENT _____ ACCES _____ EGRS _____

SMKDT _____ FINAL _____

ISSUE TEMP OCCUP _____ ISSUE OCCUP _____

STRG SHED: SITE _____ FINAL _____

SIGN: FTG _____ FINAL _____

FENCE: SITE _____ FINAL _____

MISC INSP: _____

NOTES: _____

INSPECTOR INITIALS: _____

